



*Welcome to
StarMark Cabinetry*

STARMARK®
C A B I N E T R Y





From kitchens and bathrooms, to home offices and playrooms, to family and utility rooms, StarMark Cabinetry brings beauty, function and organization to any room. See how select woods, timeless styles, striking embellishments and beautiful colors combine to give you creative freedom to express yourself and define your style.

expert craftsmanship



BOTH PAGES Bridgeport door style in Oak finished in Peppercorn with Nickel glaze



Combine exquisite wood types, expressive door styles and enduring colors to create a unique and beautiful statement in your home. Your options include warm woods like maple, oak, alder and cherry and distinctive woods like quarter sawn oak, hickory and Lyptus. Select flat panel or raised panel doors styled with elegant lines or graceful curves, understated features or luxurious details.

imagine and create



BOTH PAGES Farmington door style
in Maple finished in White. Island
is Maple finished in Mocha. Shown with
optional five-piece drawer headers.





Fairhaven inset door style in Quarter Sawn Oak finished in Pearl with Bronze glaze. Shown in Flush Inset with standard slab drawer headers.



open up to the possibilities

An extensive array of colors, door styles and well-coordinated decorative accents creates beautiful cabinetry, but we don't stop there. Our sound workmanship is guaranteed by an impressive limited lifetime warranty.



BOTH PAGES Sonoma door style in Maple finished in Caramel with Chocolate glaze



BOTH PAGES Monroe door style in Cherry finished in Harvest

*all that you
need and want*







Whatever your style, you'll find cabinets and accessories from StarMark Cabinetry that work hard, are built to last, and create a unique and memorable masterpiece in your home.

create your gourmet kitchen

BOTH PAGES Orian door style in Alder finished in Rye with Ebony glaze







Accord door style in Maple finished in Marshmallow Cream with Bronze glaze. Shown with optional five-piece drawer headers.



Tabor door style in Cherry finished in Cappuccino



Milan door style in Alder finished in Hazelnut with Ebony glaze



Tempo door style in Quarter Sawn Oak finished in Repose Grey with Chocolate glaze



Bridgeport door style in Cherry finished in Natural

start the day right

Start your day bathed in the beauty and quality of StarMark Cabinetry. Whether it's a master bath, kids' bath or half-bath, we offer you limitless design choices to express who you are.



Tempo door style in Cherry finished in Chestnut



Mackay inset door style in Maple finished in Peppercorn



ALLENTOWN

Shown in Flush Inset with standard slab drawer header

Available in these wood types:

A/C/L/M/Q/ΔA



ALEXANDRIA

Shown in Flush Inset with optional five-piece drawer header

Available in these wood types:

A/C/L/M/Q/ΔA



AMSDAHL

Shown in Beaded Inset with standard slab drawer header

Available in these wood types:

A/C/L/M/Q/ΔA



CHARLOTTE

Shown in Flush Inset with optional five-piece drawer header

Available in these wood types:

A/C/L/M/Q/ΔA



DANBURG

Shown in Beaded Inset with optional profiled drawer header

Available in these wood types:

A/C/L/M/Q/ΔA



LAFAYETTE

Shown in Beaded Inset with optional five-piece drawer header

Available in these wood types:

A/C/L/M/Q/ΔA



LAFONTAINE

Shown in Flush Inset with standard slab drawer header

Available in these wood types:

A/C/L/M/Q/ΔA



LAFOREST

Shown in Flush Inset with optional profiled drawer header

Available in these wood types:

A/C/L/M/Q/ΔA



MACKAY

Shown in Flush Inset with optional five-piece drawer header

Available in these wood types:

A/C/L/M/Q/ΔA



MERRIMAC

Shown in Flush Inset with optional profiled drawer header

Available in these wood types:

A/C/L/M/Q/ΔA



Inset cabinetry is a time honored design. Craftsmen generations ago created fine inset cabinetry for their homes and select clients. Today, you can have the clean, distinctive lines of inset cabinetry, built with quality StarMark Cabinetry construction.

For more information on inset cabinetry, visit www.starmarkcabinetry.com or ask your StarMark Cabinetry dealer for the *Inset Cabinetry* brochure.

To best illustrate the profiles, the door styles on these two pages are shown in Maple finished in Natural.

INSET WOOD TYPES

A	Alder	C	Cherry
L	Lyptus	M	Maple
ΔA	Rustic Alder	Q	Quarter Sawn Oak

Fairhaven inset door style in Quarter Sawn Oak finished in Pearl with Bronze glaze. Shown in Flush Inset with standard slab drawer headers.



DEWITT
Shown in Beaded Inset with standard slab drawer header
Available in these wood types: A/C/L/M/Q/ΔA



FAIRHAVEN
Shown in Flush Inset with standard slab drawer header
Available in these wood types: A/C/L/M/Q/ΔA



GILLETTE
Shown in Flush Inset with optional five-piece drawer header
Available in these wood types: A/C/L/M/Q/ΔA



KINGSBERRY
Shown in Beaded Inset with optional profiled drawer header
Available in these wood types: A/C/L/M/Q/ΔA



KNOTTINGHAM
Shown in Flush Inset with optional five-piece drawer header
Available in these wood types: A/C/L/M/Q/ΔA



MONTICO
Shown in Beaded Inset with optional profiled drawer header
Available in these wood types: A/C/L/M/Q/ΔA



ROCHEPORT
Shown in Flush Inset with optional five-piece drawer header
Available in these wood types: A/C/L/M/Q/ΔA



ROCK ELM
Shown in Flush Inset with optional profiled drawer header
Available in these wood types: A/C/L/M/Q/ΔA



WINTERHAVEN
Shown in Flush Inset with optional five-piece drawer header
Available in these wood types: A/C/L/M/Q/ΔA



WOODLAWN
Shown in Flush Inset with standard slab drawer header
Available in these wood types: A/C/L/M/Q/ΔA



Hudson door style in Oak finished in Java

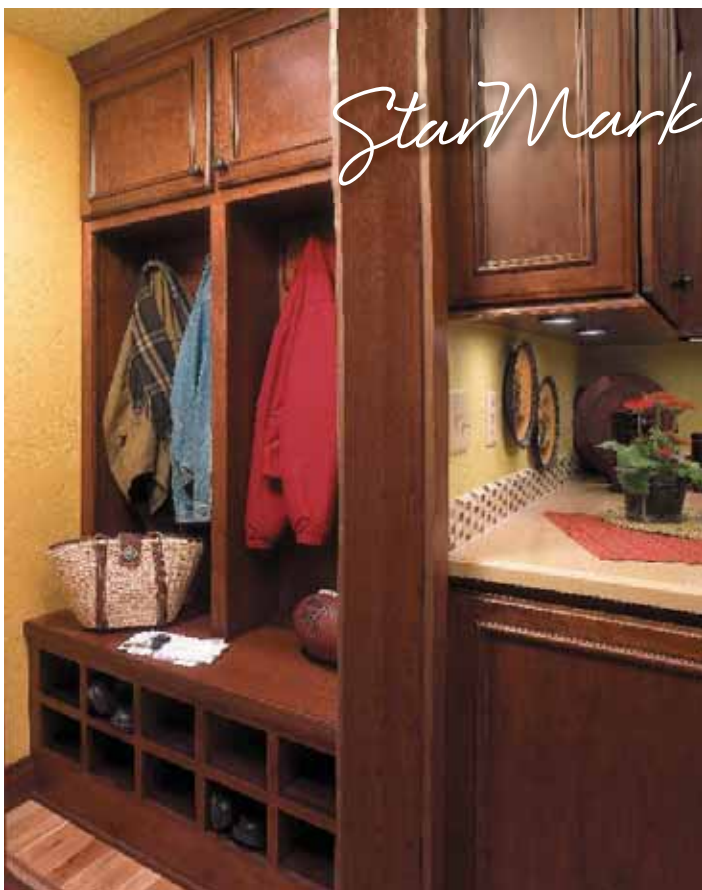

Harbor door style in Cherry finished in Nutmeg with Chocolate glaze

StarMark Cabinetry is all in

Beauty, organization and style belong in every room, because you live in your entire house, not just the kitchen. StarMark Cabinetry's innovative storage solutions suit offices, bathrooms, family rooms, utility rooms, bedrooms, playrooms and so much more.



Melbourne door style in Cherry finished in Nutmeg with Ebony glaze



Brisbane door style in Maple finished in Macadamia with Nickel glaze and Cottage Distressing



Tempo door style in Quarter Sawn Oak finished in Chestnut with Java accents



ACCORD
Available in these wood types:
A/C/H/L/M/O/ΔA,C,H



AERO
Available in these wood types:
A/C/H/M/O



ALITE
Traditional Overlay
Available in these wood types:
A/C/H/L/M/O/ΔA,C,H



ALTAMONTE
Available in these wood types:
A/C/M/ΔA



ARLINGTON
Available in these wood types:
A/C/M/ΔA



ASHFORD
Traditional Overlay
Available in these wood types:
A/C/H/M/O/ΔA



BETHANY
Available in these wood types:
C/H/M/O



BLAKELY
Traditional Overlay
Available in these wood types:
A/C/H/M/O/ΔA



BONITA
Available in these wood types:
A/C/H/M/O/ΔA



BRECKENRIDGE
Available in these wood types:
A/C/H/L/M/O/ΔA,C,H



BRIDGEPORT
Available in these wood types:
A/C/H/M/O/ΔA



BRISBANE
Available in these wood types:
C/H/M/O



EVANSVILLE
Available in these wood types:
A/C/M/ΔA



FARMINGTON
Available in these wood types:
A/C/H/L/M/O/Q/ΔA



FULLERTON
Available in these wood types:
A/C/H/L/M/O/ΔA,C,H



GALLANT
Available in these wood types:
C/L/M



GEORGETOWN
Available in these wood types:
A/C/H/L/M/O/ΔA,C,H



GLENDALE
Available in these wood types:
C/L/M



HERITAGE
Available in these wood types:
A/C/H/M/O



HUDSON
Available in these wood types:
A/C/H/L/M/O/ΔA



HUNTINGFORD
Available in these wood types:
A/C/H/L/M/O



JACKSONVILLE
Available in these wood types:
C/H/M/O



JUNEAU
Available in these wood types:
C/H/M/O



LAGUNA
Available in these wood types:
A/C/H/M/O/ΔA



OAKLEY
Available in these wood types:
A/C/H/L/M/O



ORIAN
Available in these wood types:
A/C/H/L/M/O



PACIFICA
Available in these wood types:
C/H/M/O



PARKVILLE
Available in these wood types:
A/C/M/ΔA



PEABODY
Available in these wood types:
A/C/M/ΔA



PIEDMONT
Available in these wood types:
C/H/M/O

StarMark Cabinetry offers a vast assortment of style, color, and wood type combinations to express your unique personality. Because not all doors are offered in every wood type or color, and because we introduce new products on a regular basis, please consult your StarMark Cabinetry dealer for specific availability, and visit www.starmarkcabinetry.com for the latest offerings.



AUBURN
Traditional Overlay
Available in these wood types:
A/C/H/M/O/ΔA



AUGUSTA
Available in these wood types:
C/H/M/O



AVENDALE
Available in these wood types:
A/C/H/M/O/ΔA



BARRINGTON
Available in these wood types:
A/C/M/ΔA



BEDFORD
Traditional Overlay
Available in these wood types:
A/C/H/M/O/ΔA



BELL GARDENS
Available in these wood types:
A/C/M/ΔA



CALAIS
Available in these wood types:
C/H/M



CARMEN
Available in these wood types:
C/H/M/O



CORALVILLE
Available in these wood types:
A/C/H/M/O/O/ΔA



CORONA
Available in these wood types:
C/H/M



COSMOPOLITAN
Available in these wood types:
A/C/H/M/O/O/ΔA



ELLINGTON
Available in these wood types:
A/C/M/ΔA



GRIFFON
Available in these wood types:
C/H/M/O



HAMPTON
Available in these wood types:
A/C/H/M/O



HANOVER
Available in these wood types:
A/C/H/L/M/O/ΔA



HARBOR
Available in these wood types:
A/C/H/L/M/O/ΔA



HARMONY
Available in these wood types:
A/C/H/M/O



HARRISON
Available in these wood types:
A/C/H/L/M/O/ΔA



LANCASTER
Available in these wood types:
A/C/H/M/O/ΔA



MANHATTAN
Available in these wood types:
A/C/H/L/M/O/ΔA



MEDINA
Available in these wood types:
A/C/H/L/M/O/ΔA



MELBOURNE
Available in these wood types:
A/C/H/L/M/O/ΔA



MILAN
Available in these wood types:
A/C/H/L/M/O/ΔA



MONROE
Available in these wood types:
A/C/H/M/O



PORTLAND
Available in these wood types:
A/C/H/M/O



PRESCOTT
Available in these wood types:
C/H/L/M



PRINCETON
Available in these wood types:
C/H/L/M



RAPIDS
Available in these wood types:
A/C/M/ΔA



REDCLIFF
Available in these wood types:
A/C/M/ΔA

KEY TO WOOD TYPES

- A** Alder
- C** Cherry
- H** Hickory
- L** Lyptus
- M** Maple
- O** Oak
- Q** Quarter Sawn Oak
- ΔA** Rustic Alder
- ΔC** Rustic Cherry
- ΔH** Rustic Hickory

To best illustrate the profiles, each door is shown in Maple finished in Natural.

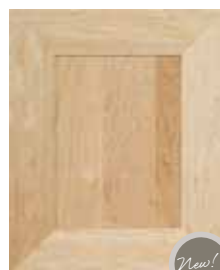
**REGAL**Available in these wood types:
C/H/M/O**RIDGEVILLE**Available in these wood types:
A/C/H/M/O/ΔA**RIVERTON**Available in these wood types:
A/C/M/ΔA**ROANOKE**Available in these wood types:
A/C/H/M/O/ΔA**ROBINSVILLE**Available in these wood types:
A/C/M/ΔA**ROMAN**Available in these wood types:
C/H/M/O**ROSEVILLE**Available in these wood types:
A/C/H/M/O/ΔA**ROYALE**Available in these wood types:
A/C/H/M/O**SALEM**Traditional Overlay
Available in these wood types:
A/C/H/M/O/ΔA**SAN DIMAS**Available in these wood types:
C/H/M/O**SENECA**Traditional Overlay
Available in these wood types:
A/C/H/M/O/ΔA**SHERIDAN**Available in these wood types:
A/C/M/ΔA**SONOMA**Available in these wood types:
C/H/M**STOCKTON**Available in these wood types:
A/C/H/L/M/O/ΔA**STRATFORD**Available in these wood types:
A/C/H/L/M/O/ΔA**SUNDANCE**Available in these wood types:
C/H/M/O**SYRACUSE**Available in these wood types:
A/C/M/ΔA**TABOR**Available in these wood types:
C/M**TEMPO**Available in these wood types:
A/C/H/L/M/O/Q**TUDOR**Traditional Overlay
Available in these wood types:
A/C/H/L/M/O/ΔA, C, H**VALLIANT**Available in these wood types:
A/C/H/L/M/O/Q/ΔA**VENICE**Available in these wood types:
A/C/M/ΔA**VENTURA**Available in these wood types:
A/C/H/L/M/O/Q/ΔA**VERONA**Available in these wood types:
C/H/M**VIOLA**Available in these wood types:
A/C/M/ΔA**WATERFALL**Available in these wood types:
A/C/H/M/O/ΔA**WAYNESVILLE**Available in these wood types:
A/C/H/M/O/ΔA**WESTERLY**Available in these wood types:
A/C/H/M/O/ΔA**WOODFIELD**Available in these wood types:
C/M**NEWBERRY**Shown in White
Rigid Thermo foil only
Available in White only

To best illustrate the profiles, each door is shown in Maple finished in Natural.



StarMark Cabinetry offers Rustic Alder, Rustic Cherry and Rustic Hickory. With Rustic wood types, wide color variation may occur, and sapwood will be more prominent. There will be "character" spots (knot, burl, blemish, etc.) on the center panels. They may also be on the stiles and rails of the door, and on the drawer front, which could impact hardware placement. Knots, if they appear, will be sound and will be closed. At certain angles, light could be visible through the knots.



custom colors and distressing

We can create cabinetry that matches any paint swatch. Bring the swatch to your StarMark Cabinetry dealer—that's all it takes to start your custom Tinted Varnish project.

If your heart's desire is a color you spied in a magazine or in a fabric, or you have furniture you want to match or complement, talk to your StarMark Cabinetry dealer about preparing a sample of wood that will guide us in creating a stain for your cabinetry. A custom stain takes more legwork (from both you and us) than a custom paint, but we'll put our heart into it. With good direction from you and our experience creating custom stains, the legwork will result in a beautiful finish you'll be proud to have in your home.

We can custom distress your custom color! Select the characteristics that you like and we will artfully apply them.

Chiseling (as seen in Homestead) | Dips | Knife cuts
 Light chain distressing | Padding (as seen in Chateaux)
 Rasping | Rounded corners | Rub through on flat surfaces
 Spattering | Speckling (dark brown, as seen in Chateaux,
 and light brown, as seen in Linen) | Worm holes
 Worn edges on center panel



Natural			Butterscotch			Rattan			Harvest			Oregano								
	Stain	Chocolate glaze		Stain	Chocolate glaze		Stain	Chocolate glaze		Stain	Chocolate glaze		Stain	Chocolate	Ebony glaze					
Alder																				
Cherry																				
Toffee			Paprika			Cappuccino			Nutmeg			Rye		Chestnut						
	Stain	Chocolate glaze		Stain	Chocolate glaze		Stain	Chocolate glaze		Stain	Chocolate glaze		Stain	Ebony glaze		Stain	Ebony glaze			
Alder																				
Cherry																				
Lyptus																				
Brittany			Burgundy			Hazelnut			Mocha		Java		Driftwood			Slate				
	Stain	Chocolate glaze		Stain	Ebony glaze		Stain	Ebony glaze		Stain	Ebony glaze		Stain	Nickel glaze	Chocolate glaze		Stain	Nickel glaze	Chocolate glaze	Ebony glaze
Alder																				
Cherry																				
Lyptus																				
Champagne			Natural		Honey		Harvest		Oregano		Toffee		Paprika		Cappuccino		Rye			
	Stain	Chocolate glaze		Stain	Chocolate glaze		Stain	Chocolate glaze		Stain	Chocolate glaze		Stain	Chocolate glaze		Stain	Chocolate glaze		Stain	Ebony glaze
Hickory																				
Oak																				
Hazelnut		Nutmeg		Chestnut		Mocha		Java		Driftwood				Slate						
	Stain	Ebony glaze		Stain	Chocolate glaze		Stain	Ebony glaze		Stain	Nickel glaze	Chocolate glaze	Ebony glaze		Stain	Nickel glaze	Chocolate glaze	Ebony glaze		
Hickory																				
Oak																				
Champagne			Natural			Honey			Butterscotch			Oregano								
	Stain	Latté glaze		Nickel glaze	Chocolate glaze		Stain	Chocolate glaze		Stain	Latté glaze		Nickel glaze	Chocolate glaze		Stain	Latté glaze		Nickel glaze	Chocolate glaze
Maple																				
Paprika		Caramel		Cappuccino		Chestnut		Mocha		Slate										
	Stain	Chocolate glaze		Stain	Latté glaze	Chocolate glaze		Stain	Chocolate glaze		Stain	Ebony glaze		Stain	Nickel glaze	Chocolate glaze	Ebony glaze			
Maple																				



Milan door style in Cherry finished in Chateaux Toffee

specialty colors

CHATEAUX

Chateaux is created by randomly applying several distressing techniques, softening all edges, padding the edges to create shadowing, and adding speckling to accentuate the distressing. A clear top coat is applied. The finish is oven cured for durability.



Tudor door style in Cherry finished in Chateaux Brittany



Alexandria inset door style in Cherry finished in Chateaux Cappuccino



Tudor door style in Rustic Cherry finished in Chateaux Nutmeg



Harmony door style in Cherry finished in Chateaux Oregano

HOMESTEAD

Several distressing techniques are applied randomly and heavily. Distressing marks are rounded corners, worn edges, knife cuts, abundant worm holes, rasping, dips, light chain distressing and chiseling. They are applied to drawers, doors and throughout the cabinetry. A protective topcoat completes the look. The finish is oven cured for durability. Homestead Fog and Homestead Red are shown here. Homestead is available on Alder and Rustic Alder door styles.



Hanover door style in Alder finished in Homestead Fog



Huntingford door style in Alder finished in Homestead Red



Danburg inset door style in Alder finished in Homestead Red. Shown with optional five-piece drawer headers.

TINTED VARNISH

color
choices

New!



Hanover door style in Maple finished in Stone with Chocolate glaze



Hanover door style in Oak finished in Stone with Chocolate glaze

Tinted Varnish on Maple mimics a painted look. The grain of the wood is not visible. Adding glaze lends character and a vintage appeal.

Tinted Varnish on Oak mimics a painted look, yet allows the graining to show. Adding glaze lends character and a vintage appeal.

		White					Dove					Marshmallow Cream				
		Tinted Varnish	Latté glaze	Bronze glaze	Nickel glaze	Chocolate glaze	Tinted Varnish	Latté glaze	Bronze glaze	Nickel glaze	Chocolate glaze	Tinted Varnish	Latté glaze	Bronze glaze	Nickel glaze	Chocolate glaze
Maple																
Oak																
Quarter Sawn Oak																
		Macadamia					Repose Grey			Ivory Cream						
		Tinted Varnish	Latté glaze	Bronze glaze	Nickel glaze	Chocolate glaze	Tinted Varnish	Chocolate glaze	Ebony glaze	Tinted Varnish	Latté glaze	Bronze glaze	Nickel glaze	Chocolate glaze		
Maple																
Oak																
Quarter Sawn Oak																
		Mushroom					Buttercream					Stone				
		Tinted Varnish	Latté glaze	Bronze glaze	Nickel glaze	Chocolate glaze	Tinted Varnish	Latté glaze	Bronze glaze	Nickel glaze	Chocolate glaze	Tinted Varnish	Nickel glaze	Chocolate glaze	Ebony glaze	
Maple																
Oak																
Quarter Sawn Oak																
		Pearl					Frost <i>New!</i>			Crystal Fog <i>New!</i>			Shale			
		Tinted Varnish	Latté glaze	Bronze glaze	Nickel glaze	Chocolate glaze	Tinted Varnish	Chocolate glaze	Ebony glaze	Tinted Varnish	Bronze glaze	Chocolate glaze	Tinted Varnish	Chocolate glaze	Ebony glaze	
Maple																
Oak																
Quarter Sawn Oak																
		Moss Green					Cranberry <i>New!</i>				Blueberry <i>New!</i>					
		Tinted Varnish	Latté glaze	Bronze glaze	Nickel glaze	Chocolate glaze	Tinted Varnish	Nickel glaze	Chocolate glaze	Ebony glaze	Tinted Varnish	Nickel glaze	Chocolate glaze	Ebony glaze		
Maple																
Oak																
Quarter Sawn Oak																
		Peppercorn				Graphite				Black						
		Tinted Varnish	Nickel glaze	Chocolate glaze	Ebony glaze	Tinted Varnish	Nickel glaze	Chocolate glaze	Ebony glaze	Tinted Varnish						
Maple																
Oak																
Quarter Sawn Oak																

This icon indicates that the finish can receive Old World Distressing, illustrated on page 30.

This icon indicates that the finish can receive Old World Distressing, illustrated on page 30.

specialty colors

AMARETTO & BORDEAUX

Amaretto and Bordeaux start with Black tinted varnish that is given rounded and worn corners. Additional worn areas on center panels expose golden butterscotch tones on the Amaretto finish and beautiful burgundy tones on the Bordeaux.



LICORICE

Licorice is Black tinted varnish. The finish is rubbed to expose worn edges and rounded corners, then Nickel glaze is applied to accent the wood and door profiles. The Licorice finish includes light chain distressing.

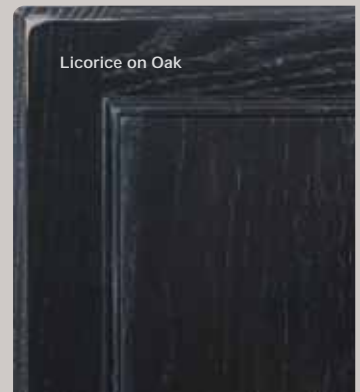

VILLA

The Villa finish for Maple results in a look that suggests brush strokes along all finished surfaces. Variation of color and finish will blend throughout the cabinetry.

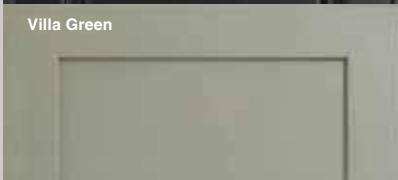

OATMEAL

Oatmeal is a warm Maple finish achieved by hand-applying Champagne stain with Chocolate glaze. It's accented with worn edges, rounded corners and light chain distressing.



LINEN

StarMark Cabinetry's beautiful Linen finishes on Maple feature Latté glazing and speckling for a softer tone, and rounded corners for an heirloom feel. Available in three distinct yet related colors—Linen White, Linen Ivory and Linen Mushroom.



old world distressing



Arlington door style in Cherry finished in Paprika with Chocolate glaze and Old World Distressing



Venice door style in Maple finished in Shale with Ebony glaze and Old World Distressing

Available on Alder, Cherry, Hickory, Maple, Oak and Quarter Sawn Oak, this look blends your new cabinetry with today's popular distressed furniture pieces. Distressing techniques are randomly applied to the face of your cabinetry throughout the design, and include **1. rounded corners 2. rasping 3. dips 4. knife cuts 5. worm holes 6. worn edges and 7. light chain distressing.** Rest assured that your new yet distressed cabinetry will have a beautiful finish with some rub-through areas and a glaze to protect the distressing and finish for many years to come.



Rapids door style in Maple finished in Peppercorn with Chocolate glaze and Old World Distressing



Augusta door style in Cherry finished in Toffee with Ebony glaze and Cottage Distressing

Cottage Distressing is created by sanding through the finish to expose **1. rounded corners** and **2. worn edges**. Adding glaze brings out the wood's unique textures. **3. Light chain distressing** is optional. A protective topcoat completes the look. Cottage Distressing is available on any stain with glaze combination, and on any Tinted Varnish with glaze combination.



Harbor door style in Maple finished in Mushroom with Chocolate glaze and Cottage Distressing and the Bridgeport door style in Cherry finished in Chestnut. Shown with optional five-piece drawer headers.



StarMark Cabinetry is CARB II compliant and ESP certified.
Kitchen Cabinet Manufacturers Association
Environmental Stewardship Program
All products impact the environment.

StarMark Cabinetry is proud to be one of the first cabinet manufacturers certified through the Environmental Stewardship Program (ESP). The Kitchen Cabinet Manufacturers Association (www.kcma.org/consumer) established ESP to certify cabinet manufacturers who prove they are using sustainable practices and products. The ESP provides tangible benchmarks by which cabinet manufacturers can be judged. Certification must be earned yearly.

StarMark Cabinetry is CARB II compliant. This means 100% of StarMark Cabinetry's products are compliant with the California Air Resources Board (CARB) Airborne Toxic Control Measure (ATCM) to reduce formaldehyde emissions from composite wood products including hardwood plywood (HWPW), medium density fiberboard (MDF), and particleboard (PB) (Title 17, California Code of Regulations §93120-93120.12). In laymen's terms, it means that StarMark Cabinetry complies with the nation's strictest regulations regarding formaldehyde.

StarMark's CARB II compliance coupled with our ESP certification is reassuring for homeowners who want to be certain they are doing business with a company that uses environmentally friendly manufacturing materials and processes.



Lafontaine inset door style in Maple finished in Marshmallow Cream. Shown in Beaded Inset with optional five-piece drawer headers.



organizational accessories

a place for everything...

Ask for the Organize & Store brochure.

...everything in its place.

door & drawer style options

Most doors and drawers can be styled with a variety of patterns and materials. Shown here is just a small sampling. To see all options, visit www.starmarkcabinetry.com or ask for the *Colors, Styles & Accents* brochure.

- | | |
|----------------------------|---------------------------------|
| 15 mullion patterns | Furniture pegs |
| 6 resin designs | Thornton accent door |
| 32 glass options | Vegetable drawer accent |
| 3 wire options | Five-piece drawer header |
| 8 faux looks | Regent drawer profile |
| 7 edge profiles | Profiled drawer header |



MULLION DOOR
with glass in the Koko Seedy pattern



INSERT DOOR
with glass in the Baroque pattern



DECORATIVE STORAGE
Insert is clear glass



INSERT DOOR
with resin insert in the Fossil Leaves pattern. Farmington door style in Cherry finished in Brittany.



THORNTON ACCENT
Insert is Leaded glass in the Radius pattern. Breckenridge door style in Cherry finished in Brittany with Chocolate glaze.



PORTAL MULLION DOOR
Insert is glass in the Glue Chip pattern. Bridgeport door style in Maple finished in Chestnut.



VENNICIA MULLION DOOR
Insert is glass in the Water pattern. Breckenridge door style in Maple finished in Marshmallow Cream with Latté glaze.



Orlan door style in Alder finished in Rye with Ebony glaze

INSET
CONSTRUCTION

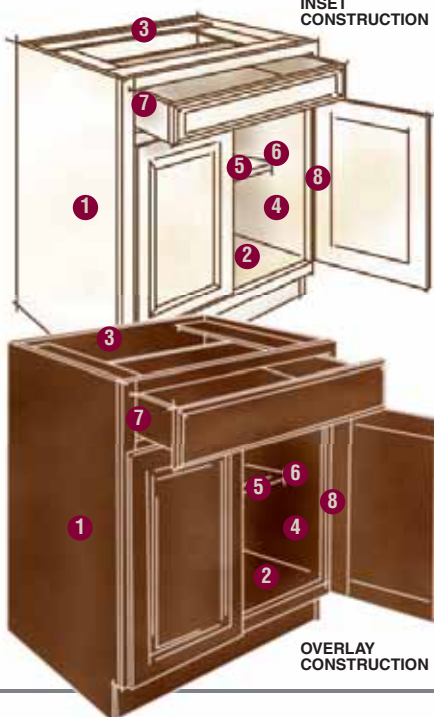

OVERLAY
CONSTRUCTION

StarMark Cabinetry Construction Details

	Overlay Construction	Inset Construction
1. End (side) Panels Several options, including	3/4" hardwood plywood veneer core-unfinished Finished, Flush, Furniture, Beaded, Decorator	3/4" hardwood plywood veneer core-unfinished Finished, Flush, Beaded, Furniture
2. Tops & Bottoms	1/2" hardwood plywood veneer core	1/2" hardwood plywood veneer core
3. Back Panels option 3/8" beaded back option 3/4" flush back	1/4" hardwood plywood 3/8" beaded back 3/4" flush back	1/2" hardwood plywood 3/8" beaded back 3/4" flush back
4. Interiors option Natural birch melamine option Stained matching veneer option Natural maple veneer	Natural birch melamine Stained matching veneer Natural maple veneer	Natural birch melamine Stained matching veneer Natural maple veneer
5. Shelves	3/4" hardwood plywood	3/4" hardwood plywood
6. Base Cabinet Shelves option Two thirds deep Full depth	Two thirds deep Full depth	Two thirds deep Full depth
7. Drawers & Rolls Trays Glides Soft close, full extension, undermount, 100 lb. capacity	3/4" hardwood birch, dovetail joinery Soft close, full extension, undermount, 100 lb. capacity	3/4" hardwood birch, dovetail joinery Soft close, full extension, undermount, 100 lb. capacity
8. Door closure	Adjustable soft close hinges	Choose from finial hinge in five colors or concealed hinge with soft close mechanism

Soft close doors, soft close drawers and 3/4" thick sides are standard!

STARMARK[®]

CABINETS

600 East 48th Street North • Sioux Falls, SD 57104

1-800-594-9444 • www.starmarkcabinetry.com

This brochure is item #1560 and is called
the "Welcome to StarMark" brochure.

© 2017 StarMark Cabinetry



Before and after transformations posted on
www.facebook.com/starmarkcabinetry



www.pinterest.com/starmarkcabinetry/



www.youtube.com/user/starmarkcabinetry



www.houzz.com/pro/starmarkcabinetry/



Twitter @CabinetStarMark



www.plus.google.com/+StarMarkCabinetry



Newsletter sign up on www.starmarkcabinetry.com



StarMark Cabinetry is made in America
by craftspeople in Sioux Falls, South Dakota.



StarMark Cabinetry is CARB II compliant
and ESP certified.

Kitchen Cabinet Manufacturers Association
Environmental Stewardship Program

All products impact the environment.

For ESP program criteria,
visit greencabinetsource.org.



StarMark Cabinetry is a
Norcraft Companies brand.

Norcraft Companies is part of
the MasterBrand Cabinets Family.

Dealers, this brochure includes these recent product introductions:
Blueberry, Cranberry, Crystal Fog, Frost and Homestead Fog
finishes, and Valliant and Ventura door styles.

This brochure was printed in May 2017.

Accuracy of all reprinted color is subject to printing limitations.

FRONT COVER Cosmopolitan door style in Cherry
finished in Slate with Ebony glaze

BACK COVER Lancaster door style in Cherry
finished in Harvest

DESIGN CREDITS

PAGES 4–5 This kitchen was designed by Sandy Blackman,
a designer on staff at Jennings Builders Supply, a StarMark
Cabinetry dealer in Fletcher, North Carolina.

PAGE 20 This home office was designed by Heather Riediger,
CKD, a designer on staff at StarMark Cabinetry.

**PAGE 21, UPPER LEFT IMAGE, BOTTOM LEFT IMAGE AND
UPPER RIGHT IMAGE** This mudroom and both family rooms
were designed by Heather Riediger, CKD, a designer on staff
at StarMark Cabinetry.

PAGE 32 This kitchen cabinetry was designed by
Kim Platt, a designer on staff at Kitchen Intuitions, a
StarMark Cabinetry dealer in Chatham, New Jersey.